

RGB CHROMOTHERAPY SHOWER HEAD :

USER MANUAL

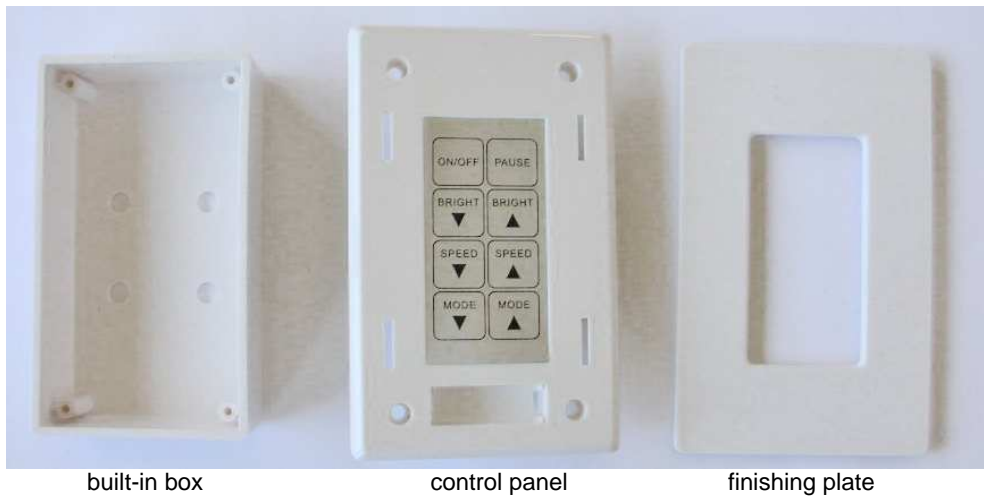

Installation:

Alike current transformer requested for the regulating-controller work absolutely as to be placed as far as possible, more then 3 meters from water supply source.

:

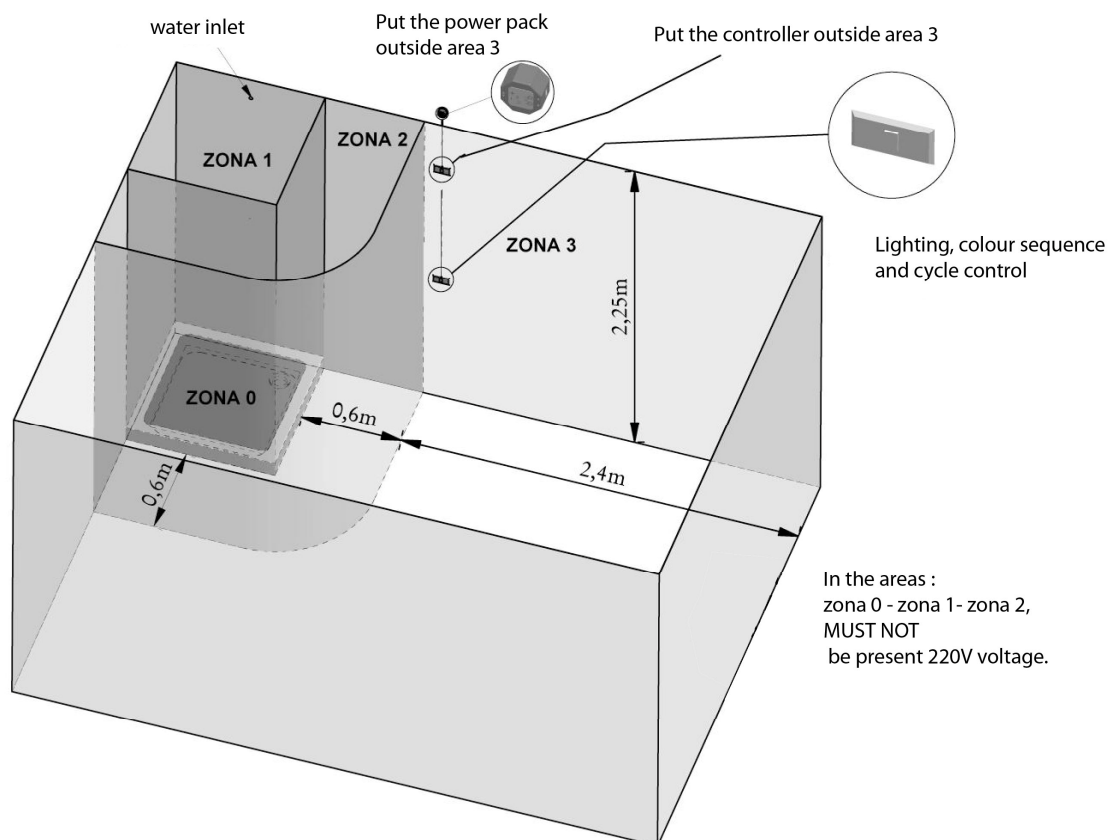

BOX CONTROLLER BUILT-IT DIMENSION:

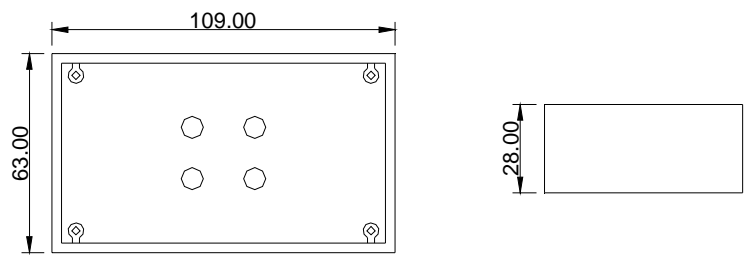

TRANSFORMER 220V-12V DIMENSIONS:

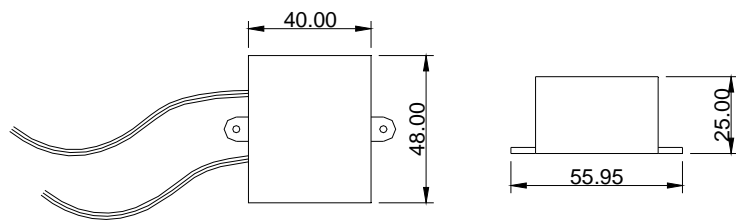

Main description:

- working temperature: -20 / +60°C
- external dimension: 120mm x 75mm x 33mm
- connection mode: common anode
- supply voltage: DC12-24V
- max load current: 4A each channel

Control panel:

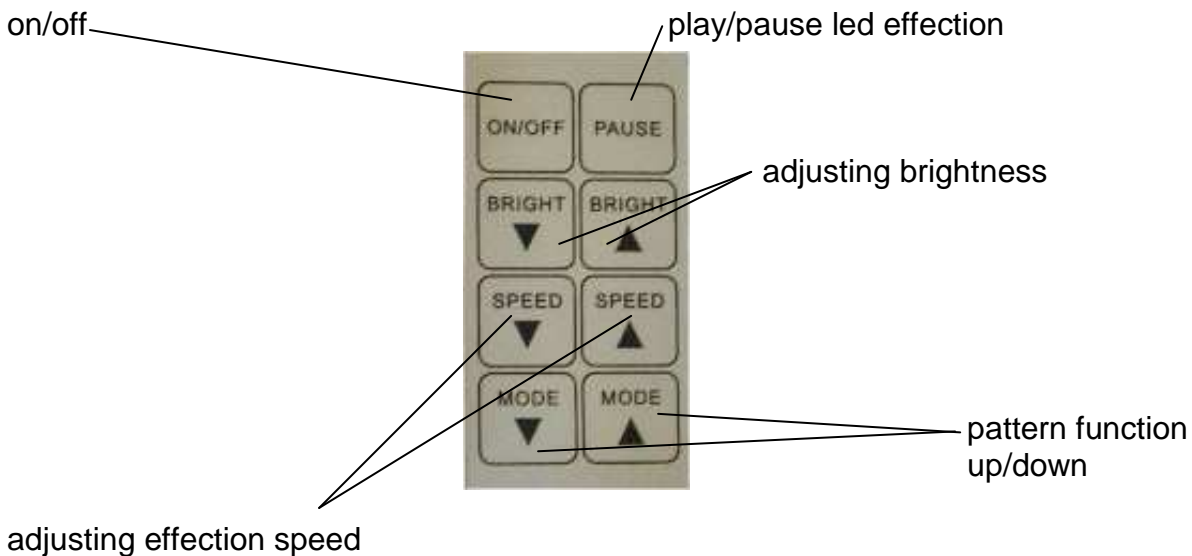

Control mode::

Adopt film button control, each film button function as follows:

- in any state you could turn on or turn off the output of controller
- when you want to see the static effecton of led you may press the pause button.
- the speed changing progression wil add one when you press SPEED button every time. There are 256 steps.
- adjusting brightness button: the brightness progression will add one when you press the BRIGHT button every time.
- MODE are the pattern function keys, up or down direction. There are 21 programs in all.

Mode changes have been listed as follows:

item	effect	note
1	static red	
2	static blue	
3	static purple	
4	static green	brightness adjustable, speed unadjustable
5	static yellow	
6	static cyan	
7	static white	
8	three colour jump changing	brightness adjustable, speed adjustable
9	seven colour jump changing	
10	three colour gradual changing	brightness unadjustable, speed unadjustable
11	seven colour gradual changing	
12	red stroboflash	
13	blue stroboflash	
14	purple stroboflash	
15	green stroboflash	brightness adjustable, speed adjustable
16	yellow stroboflash	
17	cyan stroboflash	
18	white stroboflash	
19	R/B crossfade	
20	B/G crossfade	brightness unadjustable, speed adjustable
21	G/R crossfade	

Link lines:

from the supplier:



from the shower head:



yellow

brown

green

white

warning:

- 1- supply voltage of this product is DV 12-24V: it's forbidden for AC220V
- 2- never connect two wires directly in case of short circuit
- 3- lead wire should be connected correctly according to colors that connect drawing offers.